



COUNTY OF BUNCOMBE, NORTH CAROLINA

Web Property Record Card
9658-17-3978-C0417

<< Back to Parcel Details

Date Printed: 6/11/2019

Owner Information		Parcel Information	Total Property Value: 153,800
Owners:	MITCHELL L BADER	Status:	Active
Address:	9 KENILWORTH KNLS APT 417 ASHEVILLE NC 28805-1886	Deed Date:	9/28/2015
Property Location:	9 KENILWORTH KNLS UNIT 417	Deed Book/Page:	5357 / 1664
Taxing Districts		Plat Book/Page:	0114 / 0133
County:	Buncombe County	Legal Reference:	TRANSFER BY DEED
City:	ASHEVILLE	Location:	9 KENILWORTH KNLS UNIT 417
Fire:		Class:	CONDO
School:		Neighborhood:	BEAUCATCHER HOUSE
		Subdivision:	BEAUCATCHER CONDOS
		Sub Lot:	UNIT 417
		Conservation/Easement:	N
		Flood:	N

Ownership History

Transfer Date	Price	Legal Reference	Deed Book/Page	Qualified	Vacant When Sold	Seller Names
09/28/15	\$143,500	TRANSFER BY DEED	5357 / 1664	Yes	No	NORMANDY HOLDING LLC
06/10/14	\$137,000	TRANSFER BY DEED	5215 / 1149	Yes	No	ALAN S HICKS LUCINDA G HICKS
03/26/10	\$137,600	TRANSFER BY DEED	4770 / 1749	Yes	No	BEAUCATCHER CONDOMINIUMS LLC

Assessment History

Year	Acres	Land	Bldgs	Other Impr	Assessed	Desc	Exemptions	Deferred	Taxable
2019	0.00	0	153,800	0	153,800		0	0	153,800
2018	0.00	0	153,800	0	153,800		0	0	153,800
2017	0.00	0	153,800	0	153,800		0	0	153,800
2016	0.00	0	106,400	0	106,400		0	0	106,400
2015	0.00	0	106,400	0	106,400		0	0	106,400
2014	0.00	0	106,400	0	106,400		0	0	106,400
2013	0.00	0	106,400	0	106,400		0	0	106,400
2012	0.00	0	216,800	0	216,800		0	0	216,800
2011	0.00	0	216,800	0	216,800		0	0	216,800
2010	0.00	0	216,800	0	216,800		0	0	216,800
2009	0.00	0	228,200	0	228,200		0	0	228,200
2008	0.00	0	228,200	0	228,200		0	0	228,200

Land Data	Total Acres: 0	Land Value: 0	Other Improvements Value: 0
-----------	----------------	---------------	-----------------------------

Building Structures

Res. Building ID	Style	Sq Feet	Bsmt	SqFt Bsmt	Finished	Year Built	Grade	Condition	Value
1	CONDO	995	0	0		2007	B	N	153,800

Refinement	Description	Built-Ins	Units
Foundation	PIERS	Full Baths	1
Roof Type	GABLE W/ COMP. SHGL.	Fireplace/Gas Log	1
HVAC	HEAT WITH A/C	Bedrooms	1

Section	SqFt	# Stories
OPEN PORCH	97	1
CONDO LIVING AREA 1	995	1

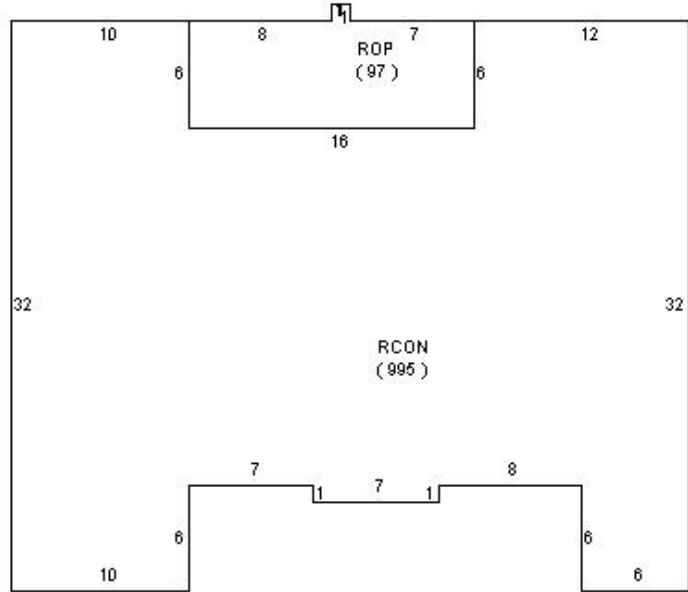

Total Building Value: 153,800